



# **TAHOE TRUCKEE** **UNIFIED SCHOOL DISTRICT**

**Measure U**  
**Safe and Modern Classrooms**  
**21<sup>st</sup> Century Learning**

**February 2, 2016**



### **2016 Projects:**

- Alder Creek Middle School: Parking Lot Upgrade/Security/21<sup>st</sup> Century Learning
- Glenshire Elementary School – Phase 2: Modernization/Security/21<sup>st</sup> Century Learning
- Sierra Expeditionary Learning School: Parking Lot Upgrade/Modernization/21<sup>st</sup> Century Learning
- Warehouse/Maintenance Facility: New Construction
- Truckee High School: Complete Track/Restroom Building/East West Field Upgrade
- Donner Trail Elementary School: Exterior Painting/Gym Interior Painting/Gym Flooring

### **2017 Projects:**

- Truckee High School - Phase 2: New Construction/Modernization/21<sup>st</sup> Century Learning
- Donner Trail Elementary School: New Construction/Modernization/21<sup>st</sup> Century Learning

### **2018 Projects:**

- Truckee Elementary School: New Construction/Modernization/21<sup>st</sup> Century Learning

# Alder Creek Middle School

## Scope of Work

### Construction Scheduled for Summer of 2016

- Add parking lot egress to Alder Drive
- Exterior lighting
- Security upgrades
- Modular classroom upgrades
- Flexible furniture
- Classroom technology package

**Project Architect: Ward Young Architects**

**TTUSD Project Manager: Rob Koster**

**Contractor: TBD**

**Site Budget: \$1,309,500**



# Alder Creek Middle School





# Donner Trail Elementary School

## Scope of Work

**Start of Construction in Spring 2018**

**Complete Construction Fall 2019**

- New construction to add two classrooms
- New restrooms
- Administration space
- Modernize existing space
- Site utilities
- Security system upgrade
- Fire alarm upgrade
- Flexible furniture
- Classroom technology package

**Project Architect: JK Architecture Partnership**

**TTUSD Project Manager: Anna Klovstad**

**Contractor: TBD**

**Site Budget: \$3,980,050**



# Donner Trail Elementary School



**DONNER TRAIL ELEMENTARY SCHOOL  
PRELIMINARY FLOOR PLAN**  
JANUARY 7, 2016

**JK** ARCHITECTURE  
PARTNERSHIP

# Donner Trail Elementary School



SOUTH PERSPECTIVE: SHED ENTRY OPTION



# Donner Trail Elementary School



SOUTH PERSPECTIVE: SHED ENTRY OPTION



# Donner Trail Elementary School



SOUTH PERSPECTIVE: SHED ENTRY OPTION

# Glenshire Elementary School



## Scope of Work

### Phase I: Summer of 2015

- Relocate front entry modular buildings
- New parking lot and bus drop-off
- Exterior lighting
- Landscape front of school entry
- Town of Truckee Safe Routes to School project

### Phase II: Summer 2016

- Front entry security improvements
- Repair roofs
- Replace flooring
- Paint interior and exterior
- Upgrade mechanical system
- Flexible furniture
- Classroom technology package

### Phase III: TBD

- Replace modular buildings with new construction as State modernization funding becomes available

**Project Architect:** Ward Young Architects

**TTUSD Project Manager:** Jim Sajdak

**Contractor: Phase I – McCuen Construction**

# Sierra Expeditionary Learning School

## Scope of Work

### Phase I: Summer 2015

- Paint interior and exterior
- Upgrade restrooms
- Add classroom sinks

### Phase II: Summer 2016

- New parking lot and drop-off
- Entry plaza
- Exterior lighting
- Fencing
- Add hard courts
- Flexible furniture
- Classroom technology package

**Project Architect:** Ward Young Architecture

**TTUSD Project Manager:** Jim Sajdak

**Contractor:** TBD

**Site Budget:** \$1,403,000





# Sierra Expeditionary Learning School - Maintenance/Operations



## LEGEND

- STRIPING
- EDGE OF PAVEMENT
- CURB/CONCRETE
- EXISTING EDGE OF ASPHALT
- SAWCUT LINE

- PROPOSED CONDITION
- 28'x12' PARENT DROP-OFF
  - 18'x12' BUILDING DROP-OFF

- PARKING SPACES



**ALTERNATIVE 1-D  
PARKING LOT LAYOUT**  
SELS / DISTRICT OFFICE / M&O BUILDING  
WARD-YOUNG ARCHITECTURE  
475.13 JANUARY 13, 2016

# Maintenance/Operations Building



## ***Tahoe Truckee Unified School District - New Maintenance & Operations Building***

Color Concept Study – January 13, 2016



**JK ARCHITECTURE PARTNERSHIP**  
100 River Place  
Troy, Ohio, C.A. 45465  
937.278.0272

1001 River Drive  
Suite 100  
Dubuque, IA 52002  
319.266.0088

[www.jkpa.com](http://www.jkpa.com)



## FLOOR PLANS

[illegible]

Page 10 of 10



**A2.**

1



# Truckee High School: Phase II New Construction/ Modernization

## Scope of Work

**Phase II:** Start Construction Spring 2017  
Complete Construction Fall 2019

- Modernize existing buildings
- Upgrade classroom roofs for snow load
- Front facade enhancement
- Upgrade building systems
- Remove modular buildings and add classrooms
- New science labs
- New elective spaces
- New science technology and math labs
- Modernize theater and reconfigure performing arts
- Enhance girls locker room
- New library
- Upgrade fire alarm
- Student quad
- Flexible furniture
- Classroom technology package
- Parking lot expansion and bus drop off

**Project Architect:** DLR Group

**TTUSD Project Manager:** Rob Koster

**Contractor:** TBD

**Site Budget:** \$ 52,708,160





# SECOND FLOOR PLAN

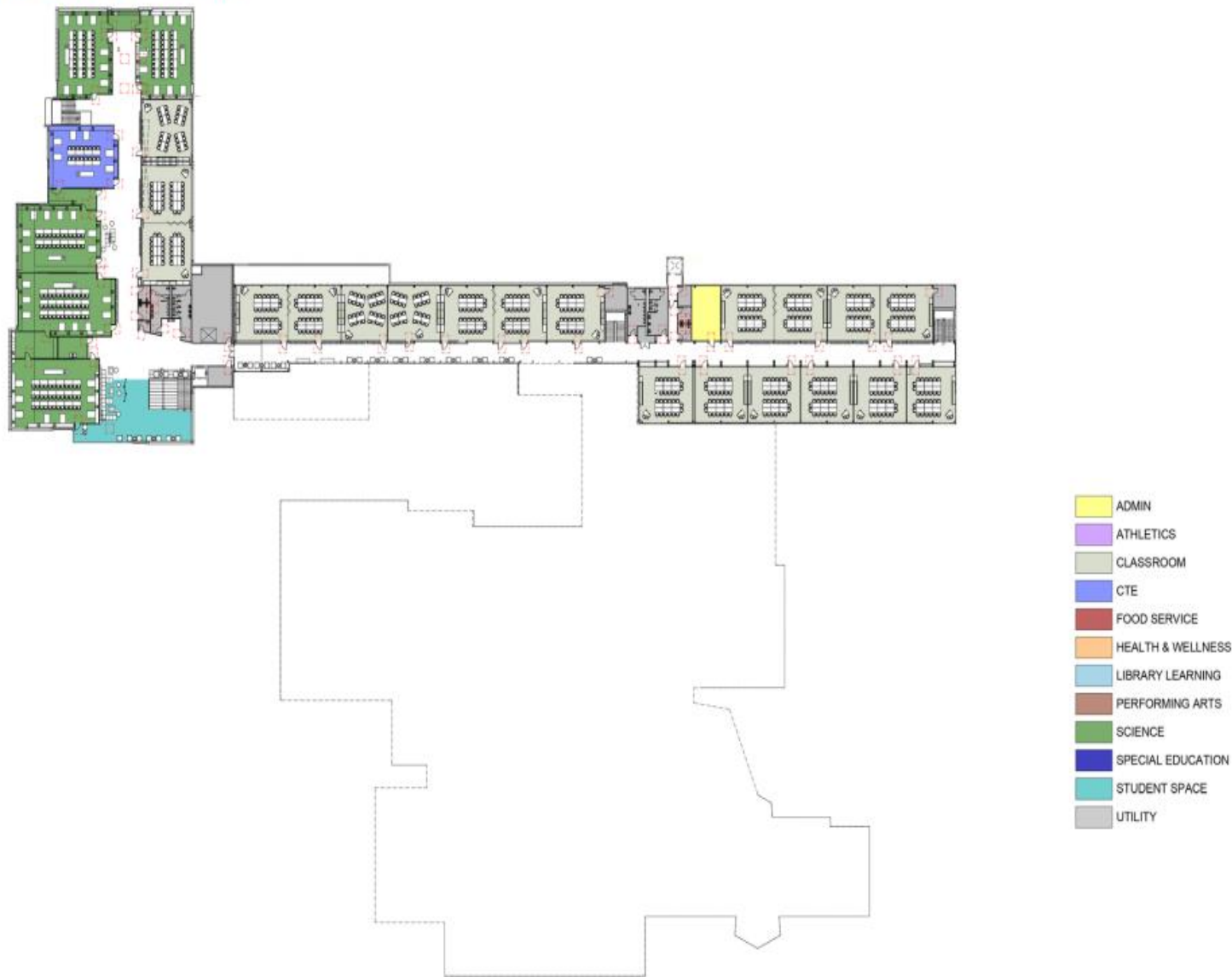



# EXTERIOR RENDERING











# EXTERIOR RENDERING



# TRUCKEE HIGH SCHOOL SITE PLAN

1. ADMIN ADDITION/ REMODEL
2. LIBRARY ADDITION / REMODEL
3. CLASSROOM WING ADDITION
4. BUS TURN AROUND
5. AUTO DROP OFF
6. PLAYFIELD FOR E.S.
7. EXISTING HIGH SCHOOL MODERNIZATION
8. STUDENT QUAD
9. OUTDOOR STAGE / LEARNING
10. SERVICE AREA / DROP OFF
11. TRASH ENCLOSURE
12. OUTDOOR COURTS
13. LEARNING COMMONS ADDITION
14. LIBRARY OUTDOOR COURT
15. GIRL'S LOCKER ROOM ADDITION
16. PARKING

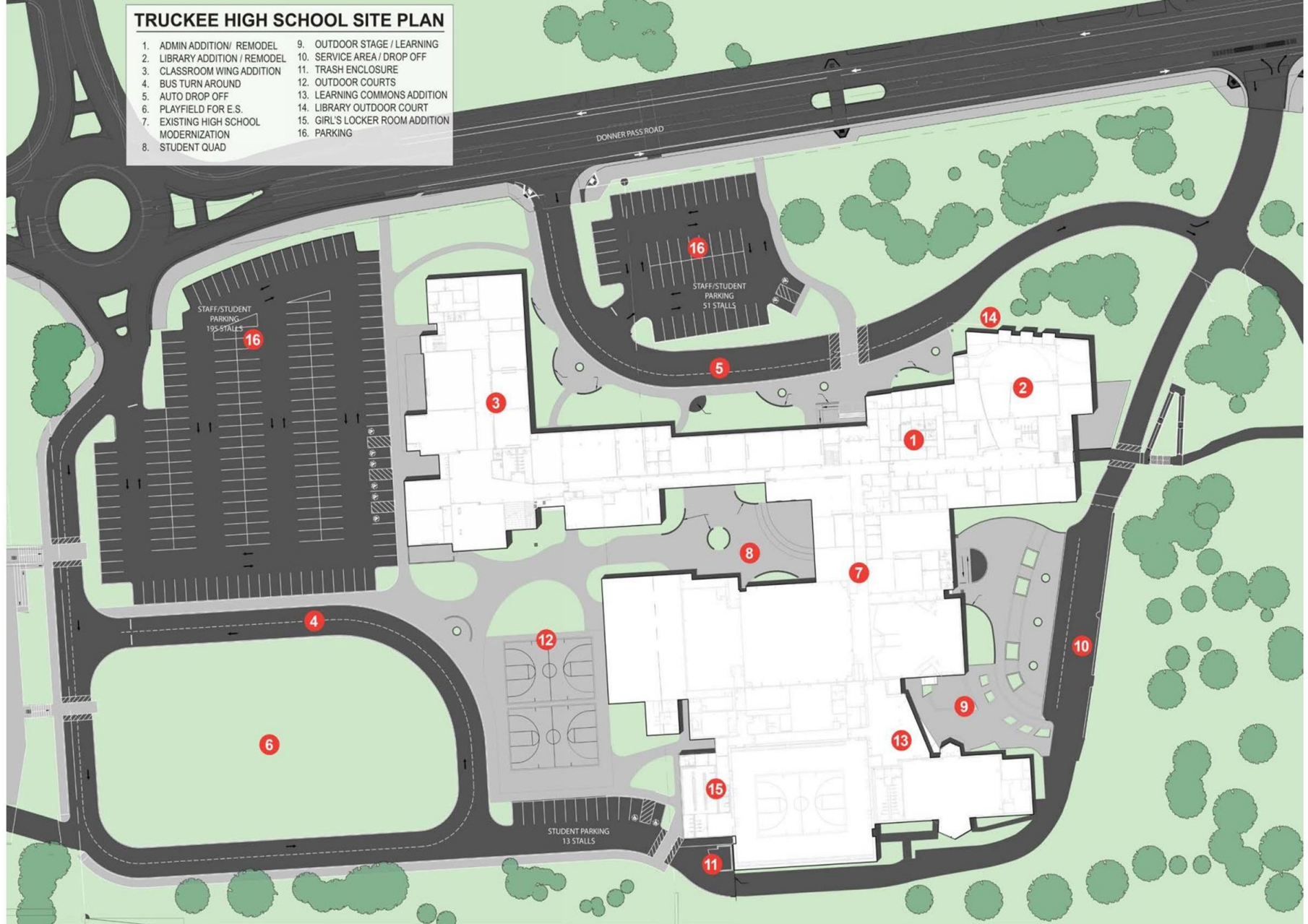



# SUSTAINABILITY

